

SYNTECHTRON

Vibratory Equipment Specialists

Syntron® Light Medium Capacity Electromagnetic Vibratory Feeders

Ideal for installation into demanding environments such as foundries, mines or heavy mineral processing plants. When suspension mounting is preferred and feed rates still low as in sampling operations, we recommend either the F152 or F212. These units are the smallest electromagnetic feeders having the same design and construction as the Syntron medium and heavy duty feeders

Model F152

12 tonnes per hour*

With a capacity of 12 tph Model F152 carries heavier troughs and greater head load. This unit is commonly used in blending, mixing, sampling and packaging operations.



Model F212

25 tonnes per hour*

Model F212 offers the same design features as the model F152, but with a maximum capacity of 25 tph



*Pictures: Top – Suspension mounted F152 Feeder with heated pan liner - Iron Ore Sample Plant,
Above – Base mounted F212 Feeder*

SYNTECHTRON

Ph: 02 9679 7022

Fax: 02 9679 7033

AUSTRALIAN OWNED

Email: sales@syntechtron.com

Website: www.syntechtron.com

Light Medium Capacity Electromagnetic Vibratory Feeders

Model F152

12 tonnes per hour *

Approx Power Consumption RC (240V 50Hz)	90 Watts
Approx Current Input	1.5 Amps
Approx Net Weight	55 kg

Trough Type	A	B	C	D	E	F	G	H	J	K	L	M	N
Standard Flat Pan	250	600	215	65	367	204	258	267	405	560	370	305	152
Specific Flat Pan	200	460	280	65	367	204	183	267	405	485	320	305	152
Specific Flat Pan	150	600	215	65	367	204	258	267	405	560	270	305	152
Specific Flat Pan	300	400	315	65	367	204	158	267	405	485	420	305	152

Model F212

25 tonnes per hour *

Approx Power Consumption RC (240V 50Hz)	150 Watts
Approx Current Input	2.5 Amps
Approx Net Weight	85 kg

Trough Type	A	B	C	D	E	F	G	H	J	K	L	M	N
Standard Flat Pan	300	700	320	75	445	305	326	320	515	691	422	380	175
Specific Flat Pan	200	900	225	75	445	305	431	320	515	616	322	380	175
Specific Flat Pan	350	500	365	75	422	305	170	297	515	575	472	380	175
Specific Flat Pan	400	600	375	75	445	305	281	320	515	686	522	380	175

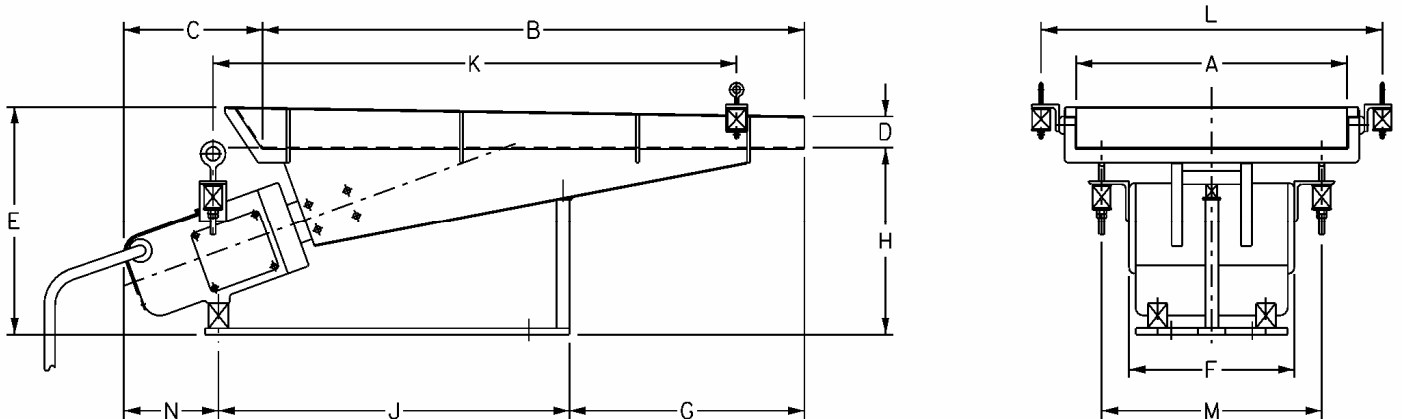

All dimensions are in mm. Have dimensions certified for installation purposes.

* Feed rate based on free flowing granular material @ 1600kg/m³ on standard flat pan.

For controller details refer separate sheet

Due to our policy of continuous improvement in product design and manufacture we reserve the right to change specifications and dimensions without notice. For correct and safe operation **Syntechtron** process equipment must be installed, operated and maintained in accordance with our instruction manual.